

• **SIZE MATTERS** •

Chapter 2

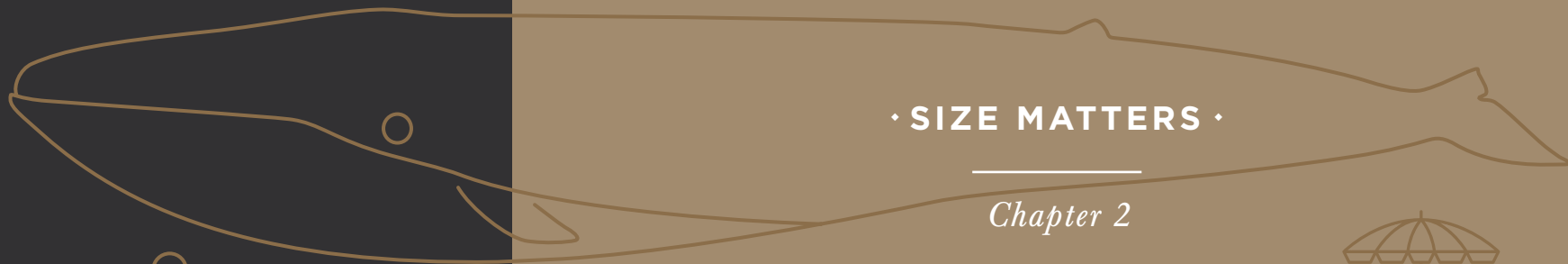



• SIZE MATTERS •

Chapter 2

Here's what you didn't know about The Minster Building.

A revolutionised iconic property which has some sizable facts and figures. The scale and impact of change throughout this Grade A building will blow you away.

The facts speak for themselves, discover just how impressive this new addition to central London really is.

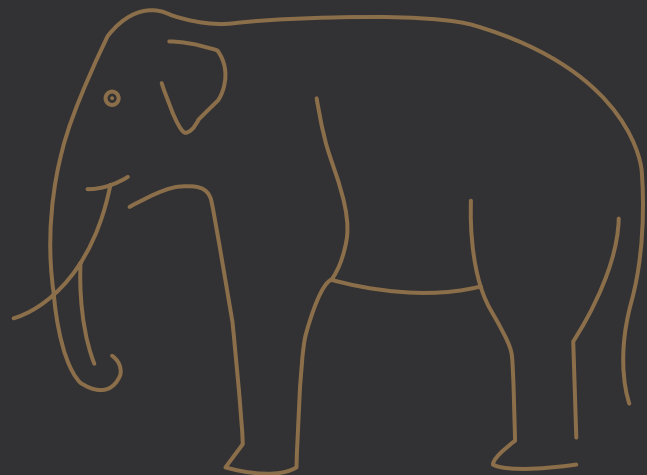

THE
• ATRIUM •

The sky's the limit

MINSTER'S ATRIUM IS 70M HIGH



The Oxo Tower = 67m

Tower Bridge = 65m

• THE MINSTER BUILDING •
LONDON



*It
would
take
over
7
Olympic
sized
swimming
pools
to
fill
the
atrium*

WWW.THEMINSTERBUILDING.COM

THE PASSENGER LIFTS

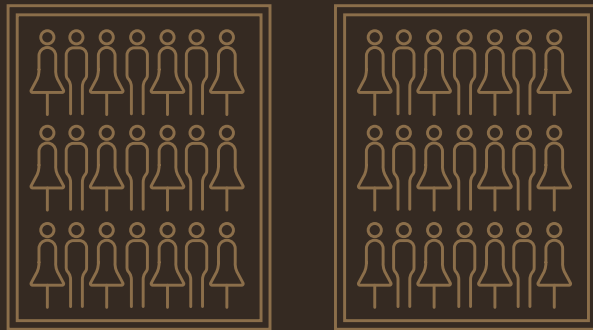
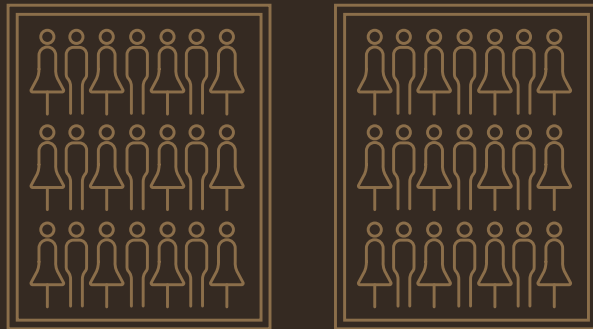

Take a trip to the stars

• THE MINSTER BUILDING •
LONDON

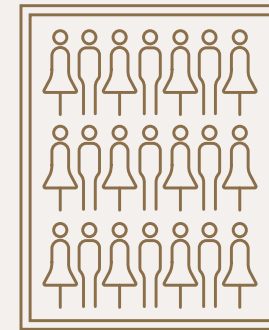
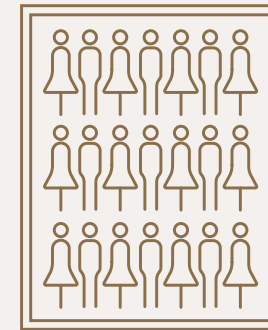
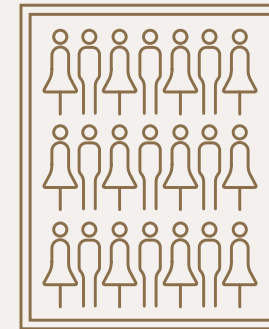
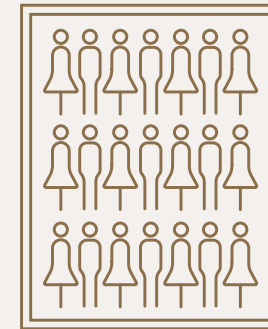

EIGHT NEW 21-PERSON PASSENGER
LIFTS SERVING ALL FLOORS

WWW.THEMINSTERBUILDING.COM

THE ◆ RECEPTIONS ◆

*Enough room to park a bus,
well 3 actually...*



8M WIDE ENTRANCE
INTO THE MAIN RECEPTION
SITUATED IN THE ATRIUM

◆ THE MINSTER BUILDING ◆
LONDON

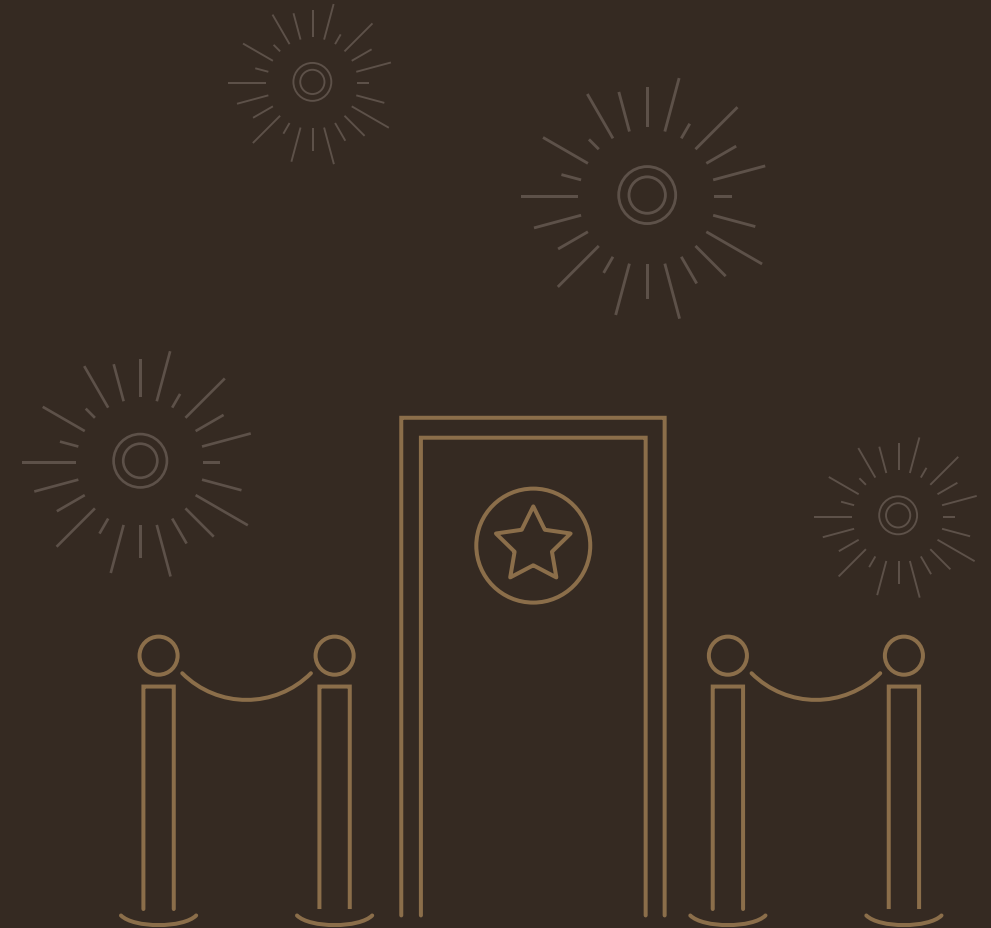

NORTHERN RECEPTION ACCESSED OFF
THE PIAZZA PROVIDES A POSSIBLE
BRANDED AND DEDICATED ENTRANCE
FOR AN OCCUPIER

WWW.THEMINSTERBUILDING.COM

THE ♦ OFFICE FLOORS ♦

Space to think - Space to succeed



Bright and spacious

OFFICE FLOOR TO CEILING HEIGHTS
FROM 2.7M - 3.3M

• THE MINSTER BUILDING •
LONDON



Space all around

THE LONGEST RUN OF SPACE
ON AN OFFICE FLOOR IS OVER 70 METRES

A place to shine

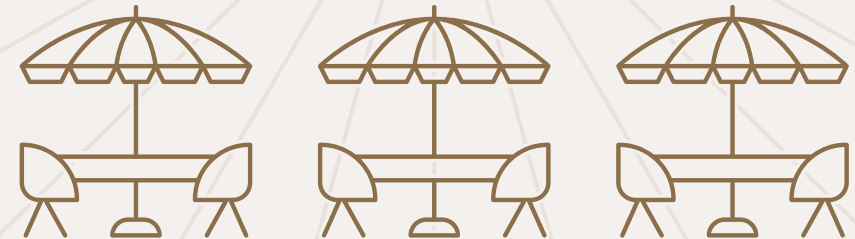

LARGE TERRACES ON ALL FLOORS
FROM THE 5TH UPWARDS

WWW.THEMINSTERBUILDING.COM

THE
♦ **FACILITIES** ♦

Bespoke spaces



250 CYCLE SPACES, 250 Z-LOCKERS,
24 SHOWERS AND A BIKE WORKSHOP AREA

♦ THE MINSTER BUILDING ♦
LONDON

THE
♦ **BUSINESS LOUNGE** ♦

Always connected



3.7M HIGH DOUBLE ENTRANCE DOORS INTO
A WIFI ENABLED BUSINESS LOUNGE WITH
PLUG-IN CHARGING POINTS

WWW.THEMINSTERBUILDING.COM

THE ◆ EFFICIENCY ◆

That's pretty cool

4M



Air conditioning

VENTILATION - 1.2 LITRES PER SQ M
1 PERSON PER 8 SQ M. ON A TYPICAL FLOOR
THAT EQUATES TO 430 PEOPLE PER FLOOR

· THE MINSTER BUILDING ·
LONDON

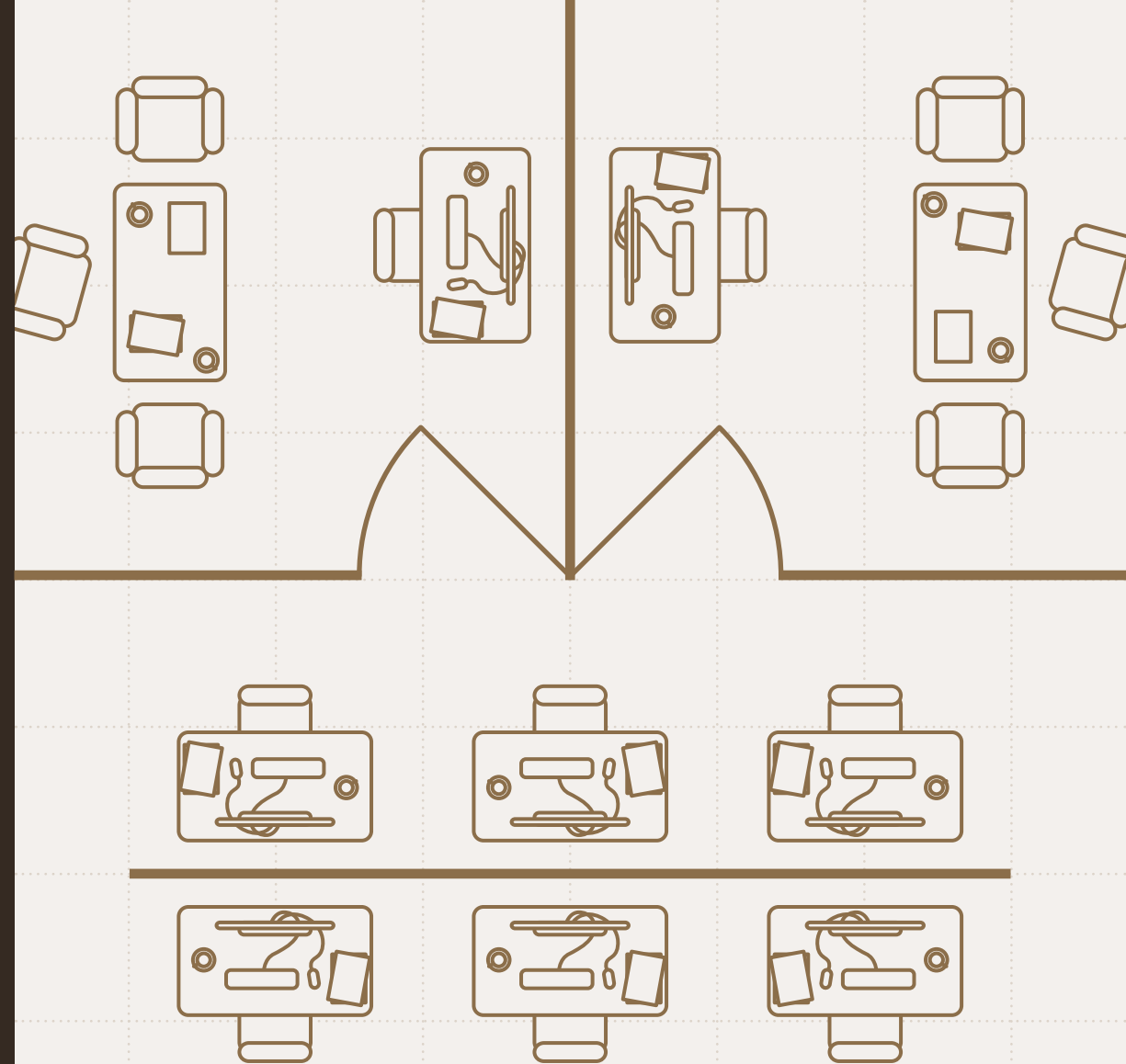

DESIGNED ON A 1.5M PLANNING GRID
DESIGNED TO ACCOMMODATE OPEN PLAN
AND CELLULAR OFFICES

WWW.THEMINSTERBUILDING.COM

THE ◆ SCHEDULE OF AREAS ◆

FLOOR	USE	TOTAL NIA (SQ FT)	APPROX TERRACE AREAS (SQ FT)
8TH	OFFICE	23,002	1,754
7TH	OFFICE	25,779	3,831
6TH	OFFICE	30,483	4,187
5TH	OFFICE	35,155	2,088
4TH	OFFICE	37,458	-
3RD	OFFICE	37,480	-
2ND	OFFICE	37,480	-
1ST	OFFICE / RETAIL	24,606	-
GROUND	OFFICE / RETAIL	26,705	-
LOWER GROUND	RETAIL	15,595	-
TOTAL		293,743	11,860

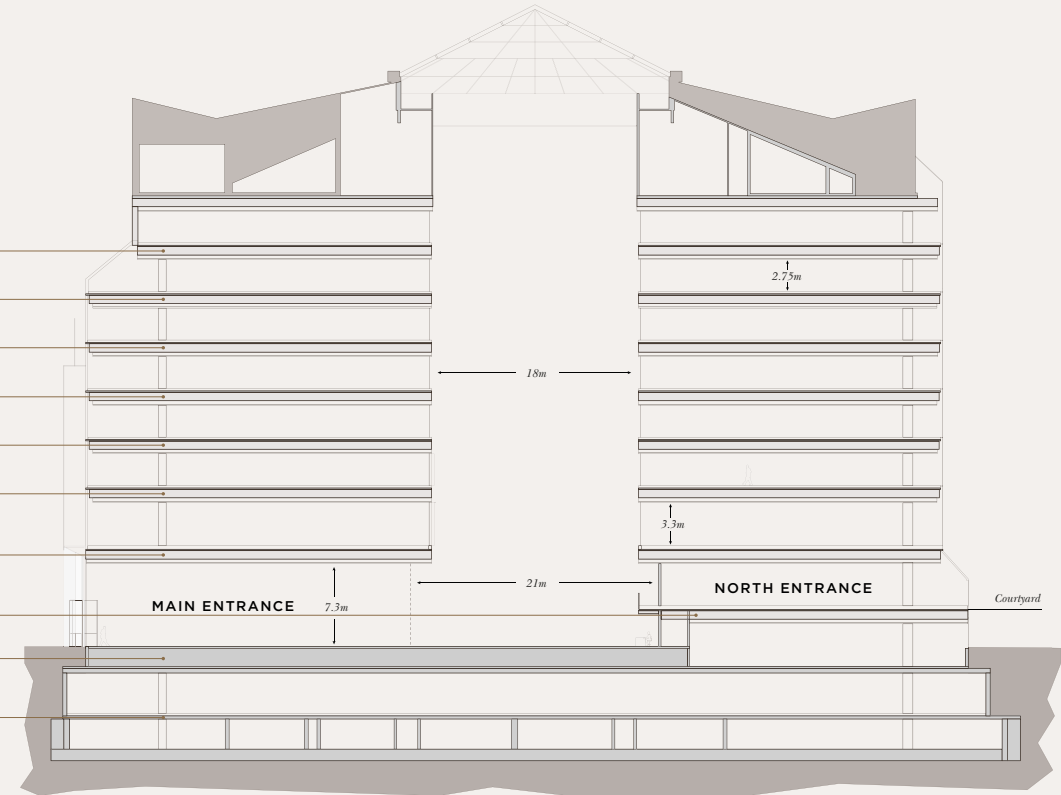

- ◆ 3,003 SQ FT OF STORAGE
- ◆ 250 CYCLE RACKS AND LOCKERS
- ◆ 8 CAR PARKING SPACES ◆
- ◆ *All areas subject to remeasurement following completion of work* ◆

· THE MINSTER BUILDING ·
LONDON



Ivanhoe
Cambridge



GM REAL
ESTATE

TEL: 020 7600 5000



CUSHMAN &
WAKEFIELD

TEL: 020 3296 2000

WWW.THEMINSTERBUILDING.COM



